

**MOTOR**

**GEARED MOTOR**

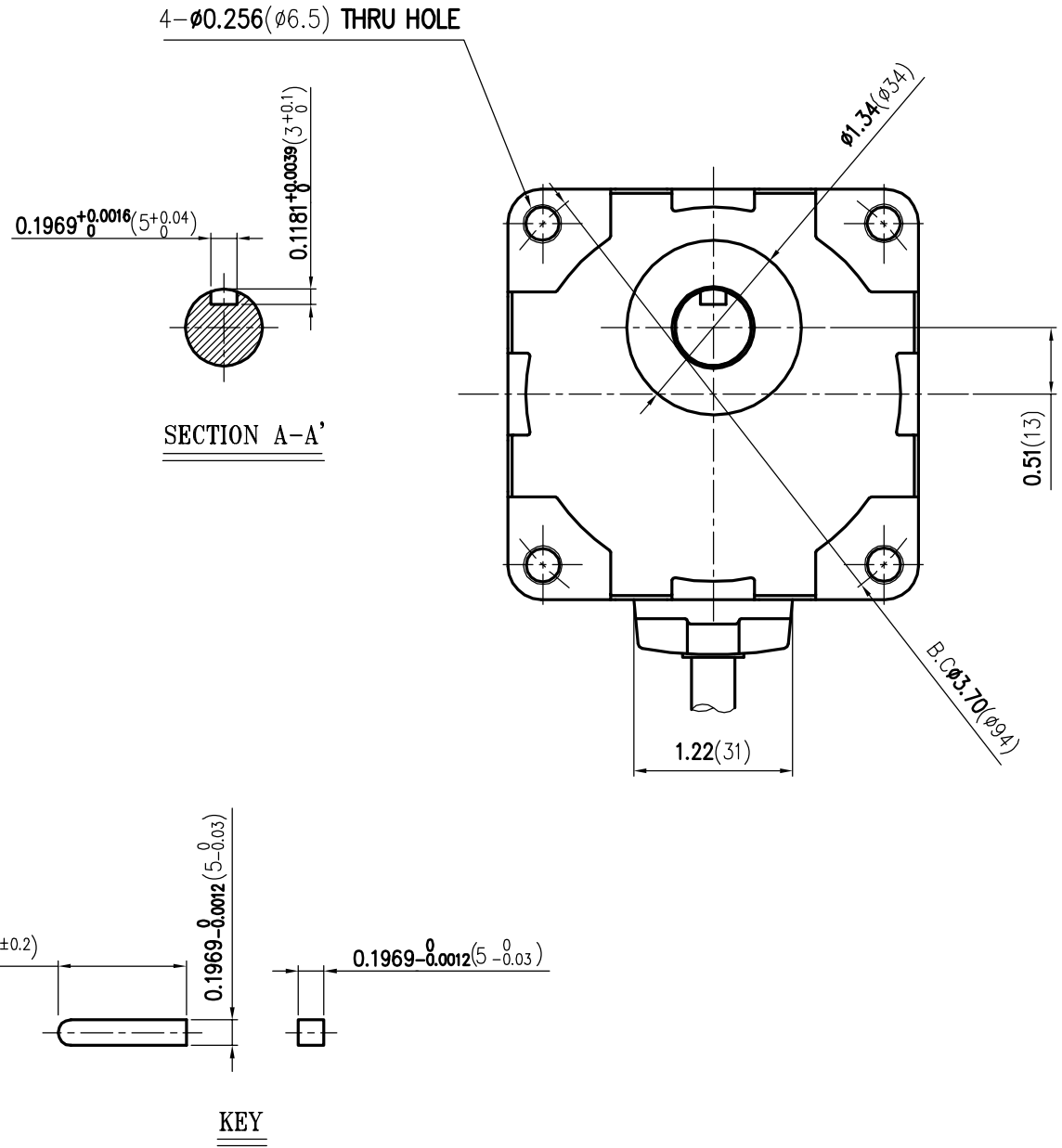

△									
△									
△									
날	사	명	변	경	내	용	변	경	이
DATE	SIGN		NOTE				REVISION		
재	표	면	척	도	1	공	차	±0.04(1.0)	
MATERIAL	SURFACE FINISH		SCALE	1/1		TOLERANCE			
제	설	검	승	도	명	BLDC GEARED MOTOR ASS'Y XWA825()-□K SERIES(1/2 PAGE)			
DRAWN	DESIGN	CHECK	APPR.		NAME				
B.H.LEE	Y.M.WON	S.H.CHA	B.Y.JEONG			SPG Co., Ltd.			
작	2013.05.03	도	2X-0001-0903						
DATE		DWG NO.							

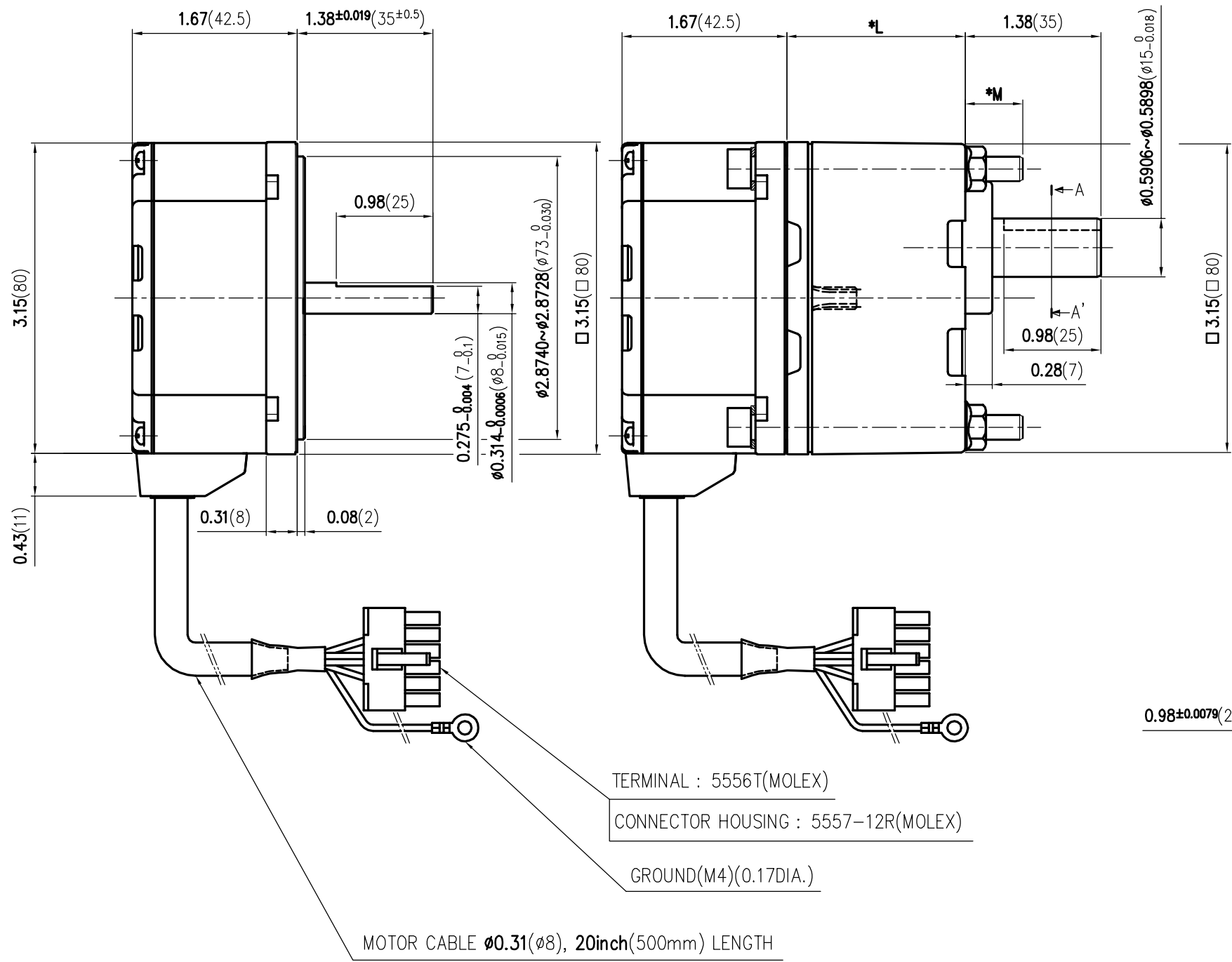
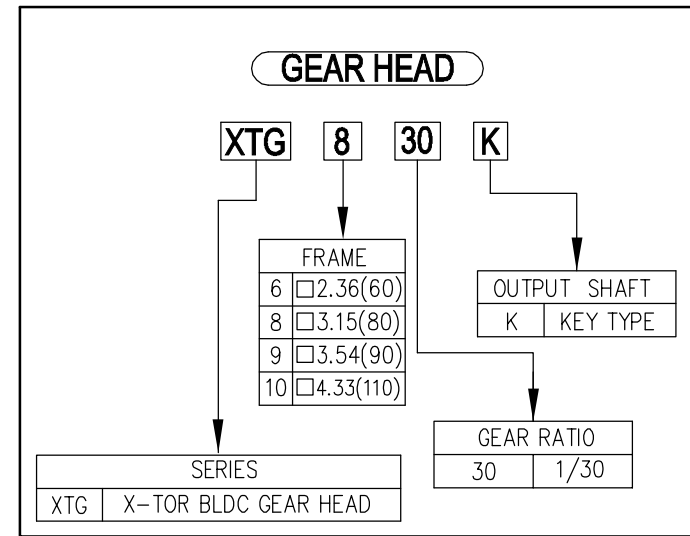
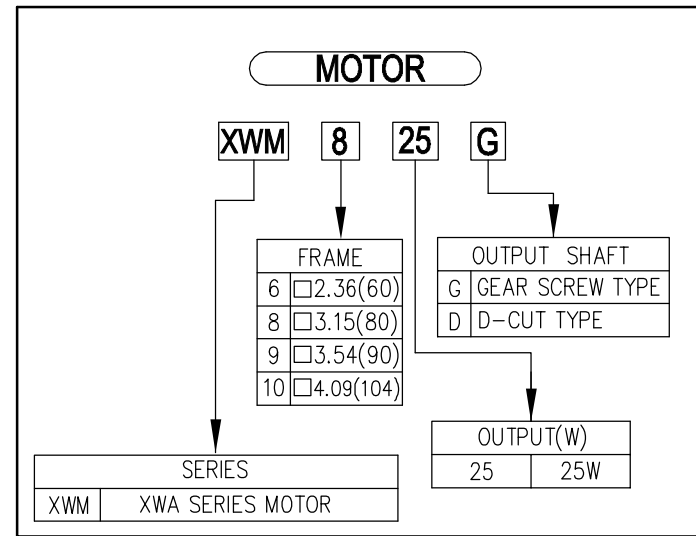

※ MOTOR / PARALLEL SHAFT GEARHEAD

PRODUCT SERIES	MOTOR	GEAR HEAD	GEAR RATIO	*L inch(mm)	SCREW SET	SCREW SET PROTRUDING LENGTH *M inch(mm)	PERMISSIBLE OVERHANG LOAD			
							0.3937(10mm) FROM END OF THE OUTPUT SHAFT		0.7874(20mm) FROM END OF THE OUTPUT SHAFT	
							N	Kgf(lbs.)	N	Kgf(lbs.)
XWA BLDC SPEED CONTROL SYSTEM (AC INPUT)	XWM825G	XTG8 SERIES SEE GEARHEAD CODING SYSTEM	5	1.61(41)	M6*L65	0.58(14.8)	200	44.05(20)	300	66.08(30)
			10, 15, 20				300	66.08(30)	400	99.12(45)
	XWM825D		30, 50, 100	1.81(46)	M6*L70	0.58(14.8)	450	99.12(45)	550	121.15(55)
			200	2.01(51)	M6*L75	0.78(14.8)				

ITEM	SPEED CONTROL RANGE [r/min.]	PERMISSIBLE TORQUE-GEARED MOTOR							
		20~400	10~200	6.7~133	5~100	3.3~67	2~40	1~20	0.5~10
	GEAR RATIO	5	10	15	20	30	50	100	200
	XWA825()-□ K	0.56 4.86(5.6)	1.12 9.72(11.2)	1.68 14.58(16.8)	2.2 19.09(22)	3.2 27.77(32)	5.3 46.00(53)	10.6 92.00(106)	16.0 138.87(160)

**NOTE**

1. UNIT : INCH (mm)
2. IP PROTECTION : IP65
3. CERTIFICATION STATUS : UL, CE, TUV, CCC

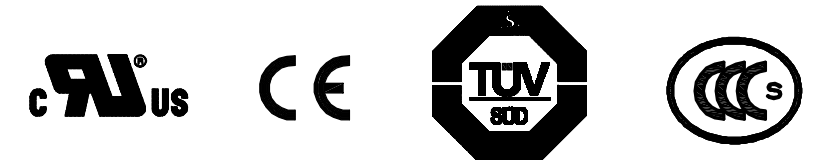

DATE		SIGN		변경 내용		변경 이유	
MATERIAL		SURFACE FINISH		SCALE		TOLERANCE	
DRAWN		DESIGN		CHECK		APPR.	
B.H.LEE		Y.M.WON		S.H.CHA		B.Y.JEONG	
				DATE		DWG NO.	
				2013.05.03		2X-0001-0903	